

Y4 We Are Textile Designers: Bean Bag Toy —Knowledge Organiser

Key Knowledge

Learn this information

KNOW YOUR MACHINE—Name of parts:

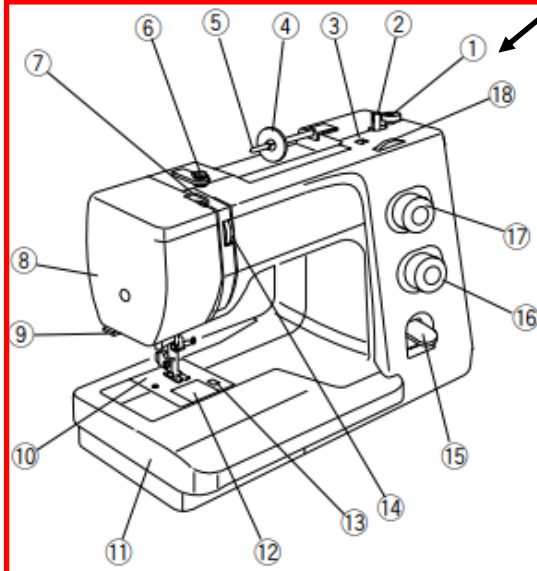

- ① Bobbin winder stopper
- ② Bobbin winder spindle
- ③ Hole for additional spool pin
- ④ Spool holder
- ⑤ Spool pin
- ⑥ Bobbin winder thread guide
- ⑦ Thread take-up lever
- ⑧ Face plate
- ⑨ Thread cutter
- ⑩ Needle plate
- ⑪ Extension table (Accessory storage)
- ⑫ Hook cover plate
- ⑬ Hook cover plate release button
- ⑭ Thread tension dial
- ⑮ Reverse stitch lever
- ⑯ Stitch length dial
- ⑰ Pattern selector dial
- ⑱ Stitch width dial

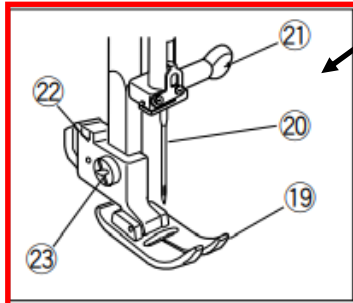

- ⑲ Presser foot
- ⑳ Needle
- ㉑ Needle clamp screw
- ㉒ Foot holder
- ㉓ Setscrew

- ㉔ Carrying handle
- ㉕ Handwheel
- ㉖ Power switch
- ㉗ Machine socket
- ㉘ Drop feed lever
- ㉙ Free-arm
- ㉚ Foot lifter

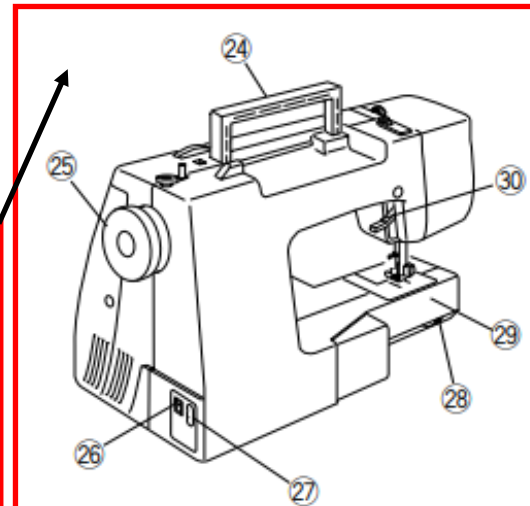

To read the full manual, visit:

<https://www.ianome.com/siteassets/support/manuals/economy-models/inst-book-7318-english.pdf>

Key Vocabulary

Understand these key words

Word	Definition
Bobbin	A bobbin is a small wood, plastic wood, or metal that holds your sewing machine thread in place.
Spool Pin	The spool pin allows the spool of thread to stay out of the machine's sewing mechanisms and permits easy access for the machine user.
Face plate	A cover which on removal gives access to the oiling points on the needle bar, presser bar and take-up lever.
Handwheel	Handwheel is this wheel that you use to turn when you want to initially wind some thread to the bobbin to secure it.
Free-arm	Free-arm sewing is used for stitching sleeves, waistbands, pant legs or any other tubular garments.
Presser foot	The metal foot that holds the fabric securely under the needle on the sewing machine.
Foot control	The pedal that you press with your foot to control the speed of the machine.
Thread	A fine cord used in sewing, weaving, and the like. Thread is usually made of two or more
Feed dogs	Metal teeth-like ridges that emerge from a hole in the throat plate of a sewing machine. Feed dogs move as you sew, gently gripping the bottom fabric to help it pass through the sewing machine and produce a high-quality stitch.

Y4 We Are Textile Designers: Bean Bag Toy —Knowledge Organiser

Key Skills - Sewing Machine—How to use:

Learn this information

SAFETY/PROTECTIVE CLOTHING:

- Do not use the sewing machine without adult supervision.
- Safety goggles—these must be worn to protect your eyes. Sometimes the needle can snap and part of the needle can ping away from the machine.
- Tie hair/any hanging items such as a tie back —these could get caught under the needle. Wearing an apron will stop any items from hanging and it will also protect your clothing.
- Ensure that your fingers and thumb are not in the needles path when it is moving.
- Only put your foot on the foot control when your hands are in a safe place.

GETTING READY TO SEW—POWER SUPPLY:

- Turn the power switch off.
- Insert the machine plug into the machine socket.
- insert the power supply plug into the wall outlet.
- Turn the power switch on.

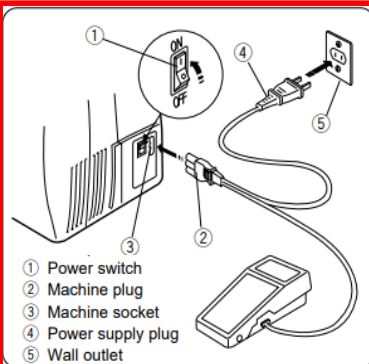

Changing the sewing direction

Stop the machine and turn the handwheel toward you to bring the needle down into the fabric. Raise the presser foot. Pivot the fabric around the needle to change sewing direction as desired. Lower the presser foot and continue sewing in the new direction.

Raising and Lowering the Presser Foot

The presser foot lifter raises and lowers the presser foot.

You can raise the foot about 1/4" (0.6 cm) higher than the normal up position for easy removal of the presser foot, or to help you place heavy fabric under the foot.

- 1 Lowered position
- 2 Normal up position
- 3 Extra up position

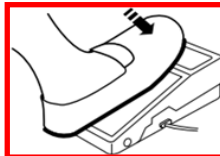
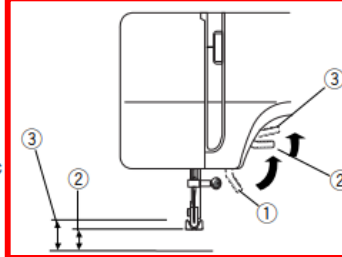

Controlling the Sewing Speed

Foot control

Sewing speed can be varied by the foot control. The harder you depress the foot control, the faster the machine runs.

Reverse Stitch Lever

Push the reverse stitch lever down to sew in reverse.

The machine will sew in reverse while the lever is pushed.

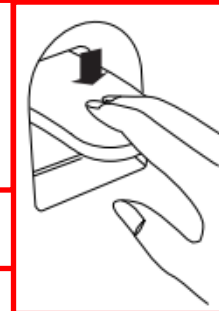
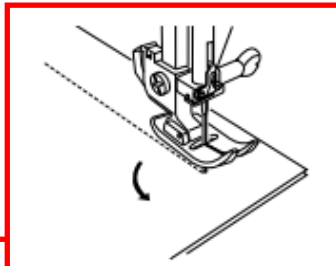

Finishing sewing

Press the reverse stitch lever and sew several stitches in reverse at the end of the seam.

Raise the presser foot and remove the fabric, drawing the threads to the back.

Starting to sew

Raise the presser foot and place the fabric under the foot.

Lower the needle into the fabric.

Lower the presser foot and smooth the threads toward the back. Depress the foot control.

Straight Stitch Sewing

Machine setting:

- 1 Stitch pattern: A
- 2 Stitch width: 0 or 5
- 3 Stitch length: 1.5 – 4
- 4 Thread tension: 2 – 6
- 5 Presser foot: Zigzag foot A

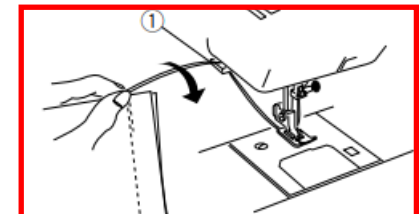
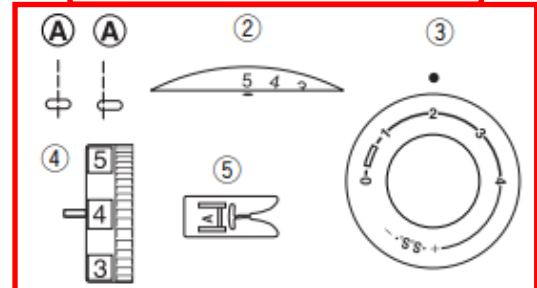

Draw the threads up and into the thread cutter. The threads are cut the proper length for starting the next seam.

- 1 Thread cutter